

# *David's Concrete Innovations*

## *Pyzique BBQ Grills*



*888-327-2846*

# *David's Concrete Innovations*

## FIRE PIT INSTRUCTIONS

The Fire Pit Kits have all of the parts that are needed. Do **NOT** use mortar between the block. You will note that there are several Kits. The only difference is the color of the block (RED, TAN, MIXED RED/GRAY and MIXED TAN/GRAY). You will need a five gallon bucket of sand or other fill material.

**Step 1.** Set the outer metal ring at the location where you want the pit. The site should be packed if it is dirt and as level as possible.

**Step 2.** DRY Stack two levels of block with the small side facing the outer metal ring but not touching. The blocks at each level should offset the lower level. Each block should have about 1/8 inch separation.



**Step 3.** Remove the outer metal ring.



**Step 4.** Pour sand and pack to 2" deep inside the block ring.

**Step 5.** Continue stacking the remaining block in patterns of your choice of colors.

**Step 6.** Reinsert the outer metal ring.

**Step 7.** Insert the interior metal ring.



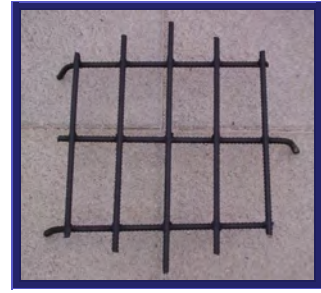

**Step 8. Install the Wood Rack in the bottom of the pit.**

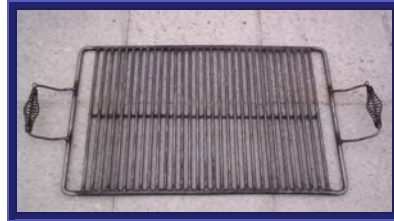

**Step 9. Install the Grill.**

**The Fire Pit is ready for wood burning. You will note that there are holes drilled in the bottom of the fire pit. This is for rain drainage.**



***Please call 888-327-2846 if you have additional questions.***

# David's Concrete Innovations

## Fire Pits and kits

- #7220 Fire Pit kits - all 3 pieces (no blocks)
- #7221 Inside Grate
- #7222 Grill
- #7223 Pit & Fire Ring
  
- #7224 Fire Pit kits w/70 gray blocks
  
- #7225 Fire Pit kits w/70 Red blocks
- #7225.1 Fire Pit kits w/70 Tan blocks
- #7225.2 Fire Pit kits w/70 Gray/Red mixed blocks
- #7225.3 Fire Pit kits w/70 Gray/Tan mixed blocks

**CALL  
FOR  
PRICING  
INFO**

## FIRE PIT DIMENSIONS

**COMPLETE FIRE PIT      WIDTH = 50" X HEIGHT = 20"**

**BASE IS 3/16" STEEL, 18" DEEP, 19" DIA.**

**INSERT IS 3/16" STEEL, 16" DEEP, 17" DIA. W/3" FLANGE**

**SAND FLOOR IS 2" DEEP**

**NEED 70 RETAINING WALL BLOCKS**